



Feel  
The Luxury



# Sai Abhishek Residency

(2/3 BHK Apartments)  
Raebareli Road, Lucknow





*Feel  
Elevated*

[www.sukritigrouplko.com](http://www.sukritigrouplko.com)



Experience the next level of grandeur and there are 10 floor of it at the Sai Abhishek Residency.

Where every home is designed to provide you with luxury of the highest order.

Along with a unique spectrum of comfort, convenience and facilities for a lifestyle that makes you feel the luxury at all times. Move up in life and arrive in style.

### FLAT TYPE - 1 (2 BHK)

(AREA : 1285 SQ.FT.) DRAWING / DINING  
+ KITCHEN + 2 BEDROOM + BALCONY



### FLAT TYPE - 2 (2 BHK)

(AREA : 1235 SQ.FT.) DRAWING / DINING  
+ KITCHEN + 2 BEDROOM + BALCONY



### FLAT TYPE - 3 (2 BHK + STORE)

(AREA : 1235 SQ.FT.) DRAWING / DINING  
+ KITCHEN + 2 BEDROOM + STORE + BALCONY





**FLAT TYPE - 4 (2 BHK + STORE)**

(AREA : 1285 SQ.FT.) DRAWING/DINING  
+ KITCHEN+ 2 BEDROOM + STORE + BALCONY



**FLAT TYPE - 5 (3 BHK)**

(AREA : 1565 SQ.FT.) DRAWING / DINING  
+ KITCHEN + 3 BEDROOM + BALCONY



# SITE LAYOUT PLAN



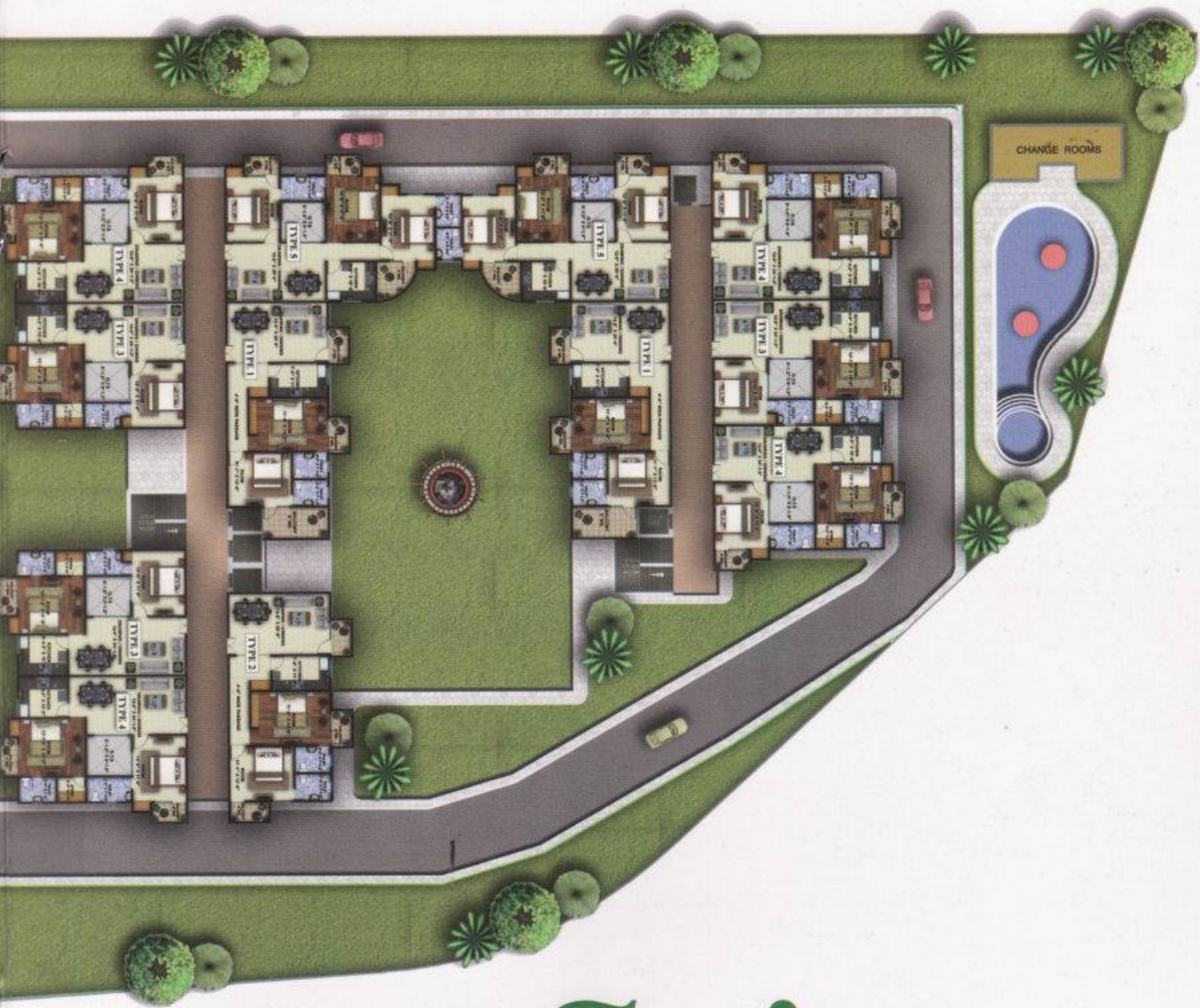

# *Sai* *Abhishek Residency*

**Raebareli Road, Lucknow**

[www.sukritigrouplko.com](http://www.sukritigrouplko.com)



## POOL SIDE VIEW

[www.sukritigrouplko.com](http://www.sukritigrouplko.com)



**NIGHT VIEW**



**GRAND ENTRY VIEW**

[www.sukritigroupplko.com](http://www.sukritigroupplko.com)

# SPECIFICATIONS

## Structure

Earthquake resistance.  
R.C.C. framed structure conforming to BIS seismic codes.



## Flooring and Finishes

**Living/Dining :** Vitrified tiles 600 mm x 600 mm  
**Bedroom :** Vitrified Tiles  
**Balcony / Toilet / Kitchen :** Antiskid ceramic tiles.  
**Kitchen :** Granite Counter with ceramic tile cladding.  
stainless steel sink provision for hot & cold water supply.

## Wall Paint

Internal Walls Living / Dining / Bedrooms finished with putty (Cement based) & Painted in pleasing Oil bound Distemper. External grade Acrylic emulsion / textured paint finish. Lift Lobby : Selected marble / Vitrified tiles / Granite cladding & oil bound distemper.



## Doors

Teak wood framed and skin lamination shutters for all doors.

## Windows

Aluminium / teak wood framed and teak wood shutters and ms grills.



## Electricity & communication

Copper electrical wiring in concealed conduit with provision for light points with standard modular switches. Provision for Intercom point in drawing-room. Provision for TV sockets in drawing, dining and all bedrooms.



# Our Running Projects



**SAI YASH**  
**RESIDENCY**  
Faizabad Road, Lucknow  
(2/3 BHK Apartments)



*Sai*  
*farm fresh*

Opp. DLF, Raebareli Road, Lucknow

**SAI ABHISHEK RESIDENCY LOCATION MAP**

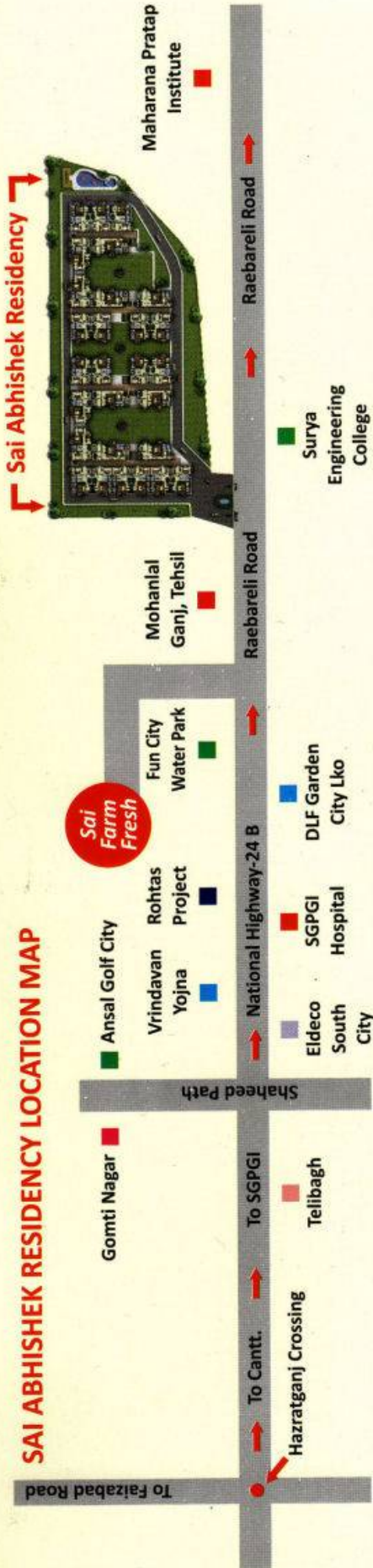

Consultant



# Sudhir & Associates

Architectural, Structural, Project Consultant, Valuers & Interior Designer

3/305, Vivek Khand, Gomti Nagar, Lucknow - 226 010

E-mail : sudhir.pandey35@gmail.com, pandeysudhir70@yahoo.in

Mobile : 09415016213

*A Project of*



## SUKRITI GROUP

CORPORATE OFFICE :

**SUKRITI SQUARE, 4/428, VIJYANT KHAND,**

**GOMTI NAGAR, LUCKNOW 226 010**

**CONTACT : 09415016213, 08765921056**

SITE OFFICE :

**1855 & 1857- K, GAURA, MOHANLALGANJ,**

**RAEBARELI ROAD, LUCKNOW**

**CONTACT : 08765921057, 08765921058**